

Transform Your Home Into a Stunning Work of Art



MOUNTAIN LAUREL HANDRAILTM

Mountain Laurel Handrails
Installed in Hawai'i



Railing Styles

Mountain Laurel Handrail – The typical installation: Mountain laurel sticks are woven into intricate patterns between 2x4 smooth red cedar boards. Sections are finished with two 1x4s and a 2x6 top cap.

The Lissara – Sections are framed with a vertical smooth red cedar 2x4 on either side and 1x2 top and bottom rails to create a shadow line of the same width around the entire panel. Panels are installed between horizontal 2x6s top and bottom.

Great Smoky – Top and bottom rails are whole rounds or natural logs. Peeled logs can be stained or painted. Mountain laurel sticks are coped to match the curve of the log.



Other Options

Wood Species – Sticks are of Mountain Laurel. Default dimensional lumber is smooth red cedar 2x4. Inquire for other species and/or surface treatments.

Paint or Stain – Paint or stain of dimensional lumber is included. Inquire for paint or stain on mountain laurel sticks. Unfinished sticks weather to a silver color.

MOUNTAIN LAUREL HANDRAIL™

Mountain Laurel Handrails are unique guardrails for residential and commercial buildings. These woven branch railings are custom-crafted by skilled artisans in the Great Smoky Mountains. Mountain Laurel Handrails are available delivered to job sites nationwide.

There is no better or easier way to instantly enhance the exterior façade and curb appeal of a building. Each railing section is built to specification and the typical railing can be modified to match any design. Custom options include dimensional lumber species, stain or paint on the sticks, modified railing design, and log rails.

Mountain Laurel Handrails are a perfect fit for a rustic styled, log or timber frame building but also work well with more modern décor. Since handrail sections arrive preassembled and ready-to-install, AND are easily installed by a skilled carpenter, construction cycle time is shortened and labor costs are significantly less than site-built systems.

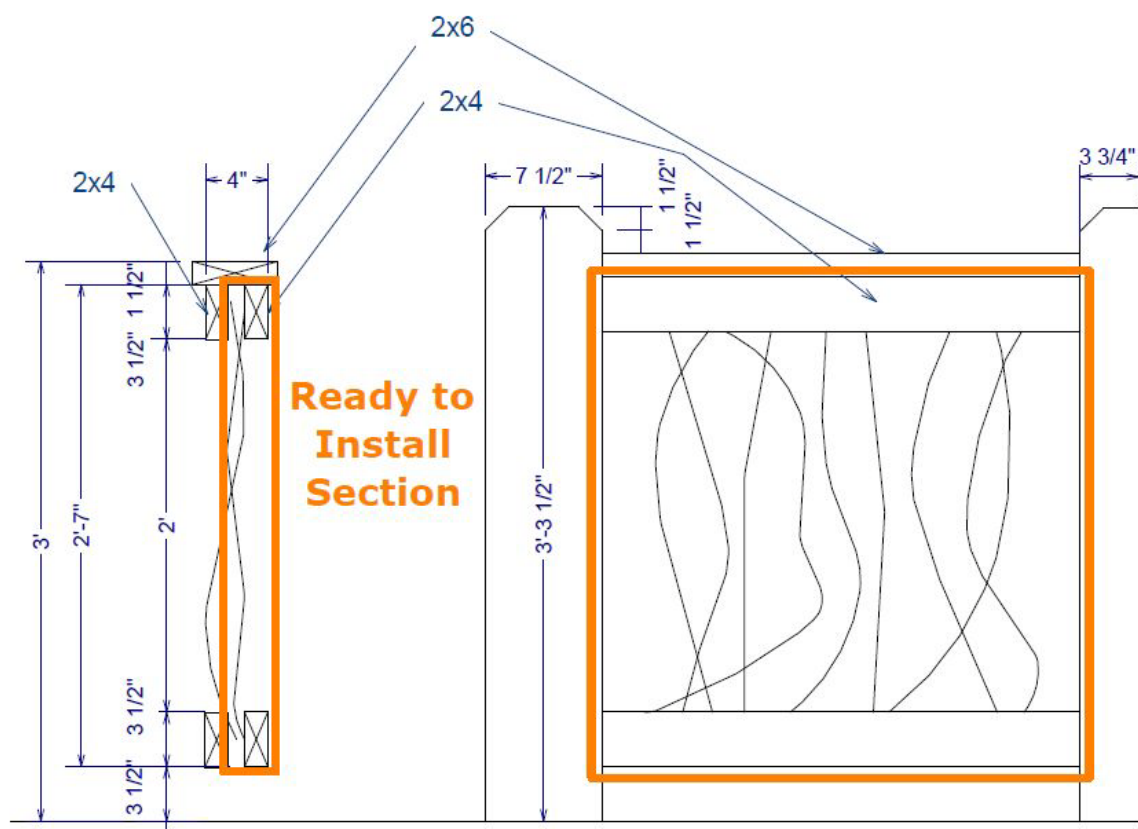

Typical Railing Installation

Additional 2x4s, 2x6, and posts not included.
All openings in woven branches less than 4" diameter.

Standard Pricing

Mountain Laurel Handrails	\$105 per linear foot
Lissara Style	\$120 per linear foot
Curved Railings	\$150/lf + \$350 jig setup
Great Smoky Laurel Logs	\$220 per linear foot
Great Smoky Bark On Locust	\$260 per linear foot
Great Smoky Peeled Locust	\$280 per linear foot
Sticks Cleaned	\$10 per linear foot
Sticks Stained	\$20 per linear foot
Sticks Painted or Polyed	\$30 per linear foot
Sections Taller than 31"	\$10/lf and up
Alternate Lumber Spec	\$10/lf and up
Mountain Laurel Branch Banister	\$20 per linear foot
Locust Branch Banister	\$30/lf and up
Mountain Laurel Material	\$240 per bundle

MOUNTAIN LAUREL HANDRAIL™



Product Information Guide



awoodrailing.com
info@awoodrailing.com
828 342 0873